



NIMMI 

CONCEALED HINGES



NIMMI APP



Features

- Opening angle 110°
- Range of door thickness 14-24mm
- Possible cup distance (K Value) 3-7mm
- Compliant to system 32
- Tested for 50,000 cycles
- Twin spring for controlled opening
- Made up of carbon steel with zinc plating
- Integrated overlay and depth adjustment upto ± 2 mm

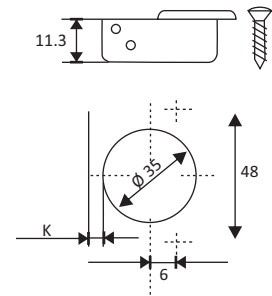
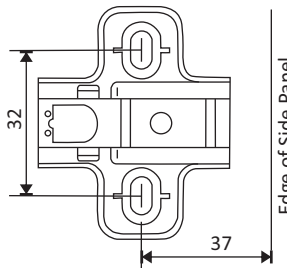

Reveal Calculation

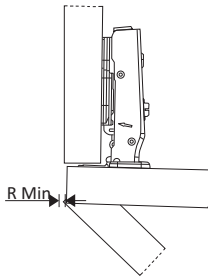

	T	14	15	16	17	18	19	20	21	22	23	24
K=3	R	0.2	0.4	0.6	0.8	1.1	1.5	2	2.7	3.5	4.3	5.1
K=4	R	0.2	0.4	0.6	0.8	1.1	1.4	1.9	2.4	3.1	3.9	4.7
K=5	R	0.2	0.3	0.5	0.8	1.0	1.4	1.8	2.3	2.9	3.5	4.3
K=6	R	0.2	0.3	0.5	0.7	1.0	1.3	1.7	2.1	2.6	3.3	4
K=7	R	0.2	0.3	0.5	0.7	0.9	1.2	1.6	2	2.5	3	3.7

Gap Calculation

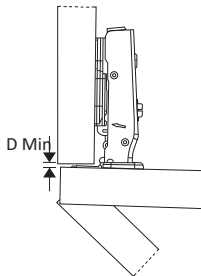

	T	14	15	16	17	18	19	20	21	22	23	24
K=3	D	0.0	0.0	0.0	0.1	0.3	0.5	0.7	0.8	1.0	1.2	1.4
K=4	D	0.6	0.8	1.0	1.1	1.3	1.5	1.7	1.8	2.0	2.2	2.3
K=5	D	1.6	1.8	1.9	2.1	2.3	2.5	2.6	2.8	3.0	3.2	3.3
K=6	D	2.6	2.8	2.9	3.1	3.3	3.4	3.6	3.8	4.0	4.1	4.3
K=7	D	3.6	3.7	3.9	4.1	4.3	4.4	4.6	4.8	5.0	5.1	5.3

The above values are calculated for squared edges (0.8mm Edge), they are reduced for radiussed edges.

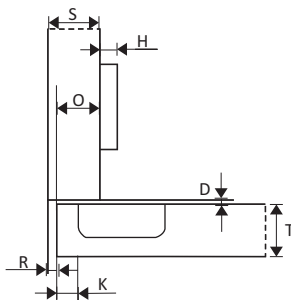

NAHSL001
O = 12 + K

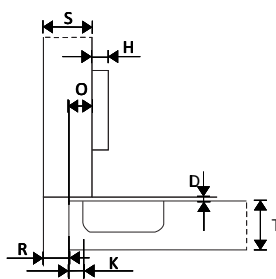

NAHSL002
O = 5 + K

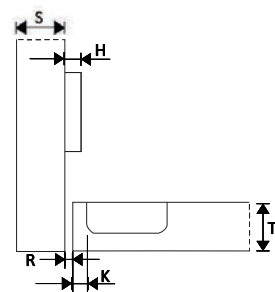

NAHSL003
O = -4 + K



Features

- Opening angle 165°
- Range of door thickness 14-26mm
- Possible cup distance (K Value) 3-8mm
- Compliant to system 32
- Tested for 50,000 cycles
- Twin spring for controlled opening
- Zero protrusion at maximum opening angle
- Made up of carbon steel with zinc plating
- Integrated overlay and depth adjustment upto ± 2 mm

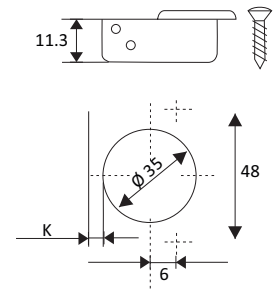
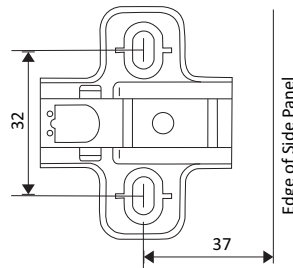

Reveal Calculation

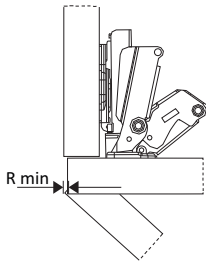

	T	14	15	16	17	18	19	20	21	22	23	24
K=3	R	0	0	0	0	0	0	0	0	0	0.2	0.6
K=4	R	0	0	0	0	0	0	0	0	0	0.3	0.7
K=5	R	0	0	0	0	0	0	0	0	0	0.3	0.9
K=6	R	0	0	0	0	0	0	0	0	0	0.3	0.8
K=7	R	0	0	0	0	0	0	0	0	0	0.2	0.6
K=8	R	0	0	0	0	0	0	0	0	0	0.2	0.5

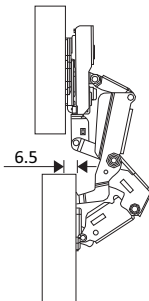

Diagram showing door protrusion of 6.5mm at 90° opening angle.

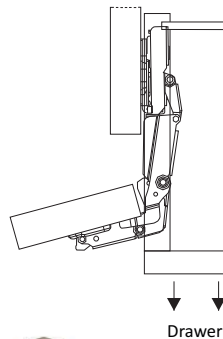
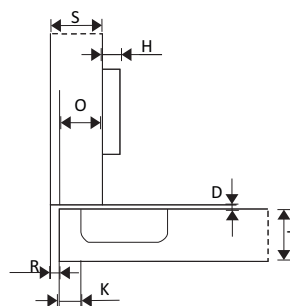

Diagram showing zero door protrusion at maximum opening angle.



NAHSL007

$$O = 12 + K$$



Features

- Opening angle 109°
- Range of door thickness 14-22mm
- Possible cup distance (K Value) 3-7mm
- Compliant to system 32
- Tested for 50,000 cycles
- Economical slide on hinge with soft closing
- Made up of carbon steel with zinc plating
- Integrated overlay and depth adjustment upto ± 2 mm

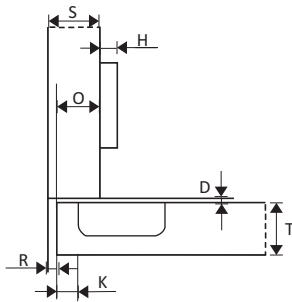
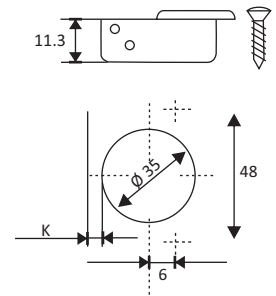
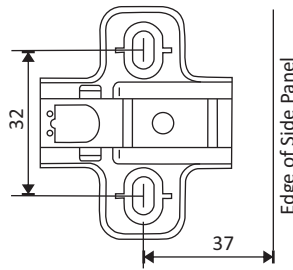

NAHSL061
 $O = 12 + K$

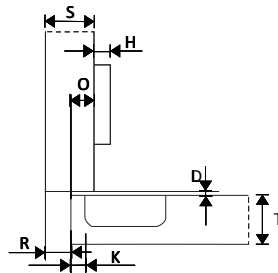

NAHSL062
 $O = 5 + K$

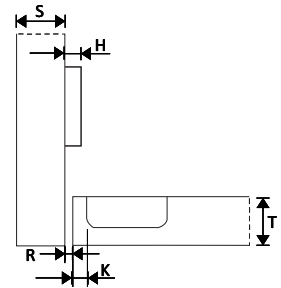

NAHSL063
 $O = -4 + K$



Features

- Opening angle 110°
- Range of door thickness 14-24mm
- Possible cup distance (K Value) 3-7mm
- Compliant to system 32
- Tested for 50,000 cycles
- Twin spring for controlled opening
- Cam adjustable depth and clip-on mechanism
- Made up of carbon steel with zinc plating
- Integrated overlay and depth adjustment upto ± 2 mm

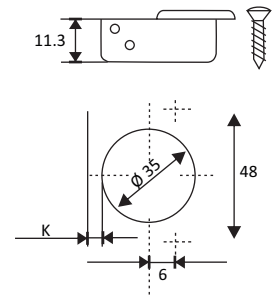
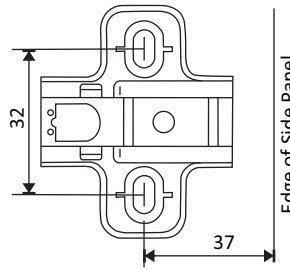

Reveal Calculation

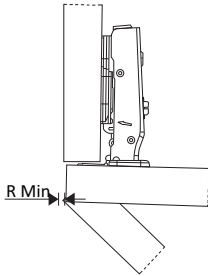

	T	14	15	16	17	18	19	20	21	22	23	24
K=3	R	0.2	0.4	0.6	0.8	1.1	1.5	2	2.7	3.5	4.3	5.1
K=4	R	0.2	0.4	0.6	0.8	1.1	1.4	1.9	2.4	3.1	3.9	4.7
K=5	R	0.2	0.3	0.5	0.8	1.0	1.4	1.8	2.3	2.9	3.5	4.3
K=6	R	0.2	0.3	0.5	0.7	1.0	1.3	1.7	2.1	2.6	3.3	4
K=7	R	0.2	0.3	0.5	0.7	0.9	1.2	1.6	2	2.5	3	3.7

Gap Calculation

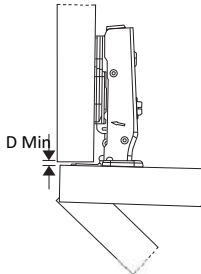

	T	14	15	16	17	18	19	20	21	22	23	24
K=3	D	0.0	0.0	0.0	0.1	0.3	0.5	0.7	0.8	1.0	1.2	1.4
K=4	D	0.6	0.8	1.0	1.1	1.3	1.5	1.7	1.8	2.0	2.2	2.3
K=5	D	1.6	1.8	1.9	2.1	2.3	2.5	2.6	2.8	3.0	3.2	3.3
K=6	D	2.6	2.8	2.9	3.1	3.3	3.4	3.6	3.8	4.0	4.1	4.3
K=7	D	3.6	3.7	3.9	4.1	4.3	4.4	4.6	4.8	5.0	5.1	5.3

The above values are calculated for squared edges (0.8mm Edge), they are reduced for radiussed edges.

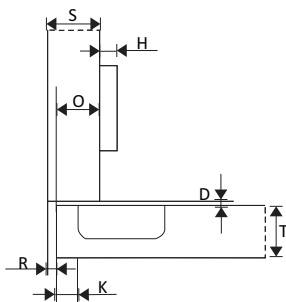

NAHCL021
O = 12 + K

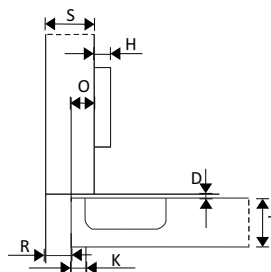

NAHCL022
O = 5 + K

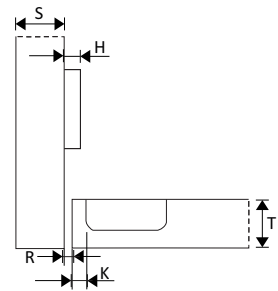

NAHCL023
O = -4 + K



Features

- Opening angle 165°
- Range of door thickness 14-26mm
- Possible cup distance (K Value) 3-8mm
- Compliant to system 32
- Tested for 50,000 cycles
- Twin spring for controlled opening
- Zero protrusion at maximum opening angle
- Cam adjustable depth and clip-on mechanism
- Made up of carbon steel with zinc plating
- Integrated overlay and depth adjustment upto ± 2 mm

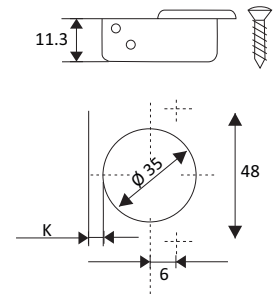
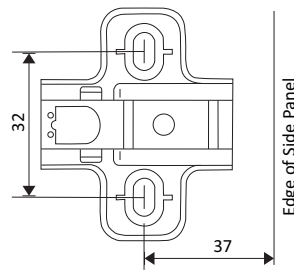

Reveal Calculation

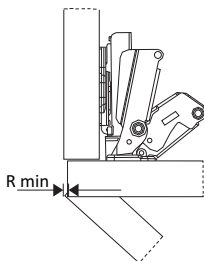

	T	14	15	16	17	18	19	20	21	22	23	24
K=3	R	0	0	0	0	0	0	0	0	0	0.2	0.6
K=4	R	0	0	0	0	0	0	0	0	0	0.3	0.7
K=5	R	0	0	0	0	0	0	0	0	0	0.3	0.9
K=6	R	0	0	0	0	0	0	0	0	0	0.3	0.8
K=7	R	0	0	0	0	0	0	0	0	0	0.2	0.6
K=8	R	0	0	0	0	0	0	0	0	0	0.2	0.5

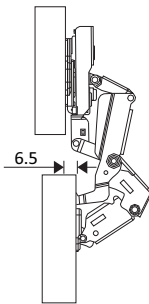

Diagram showing door protrusion of 6.5mm at 90° opening angle.

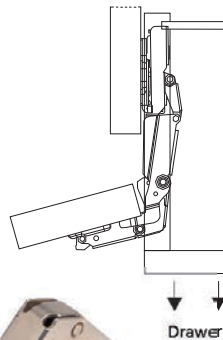
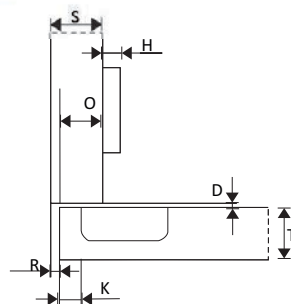

Diagram showing zero door protrusion at maximum opening angle.



NAHCL027

$$O = 12 + K$$



Features

- Opening angle 125°
- It can be used for full overlay, half overlay as well as inset application by adjusting the cup distance
- For application on sandwiched mirror glass
- Range of door thickness(3-6mm)
- Possible cup distance (0-16mm)
- Made up of carbon steel with zinc plating
- Integrated overlay and depth adjustment upto ± 2 mm

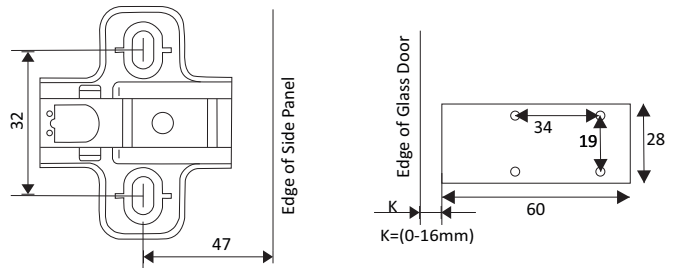

Reveal Calculation

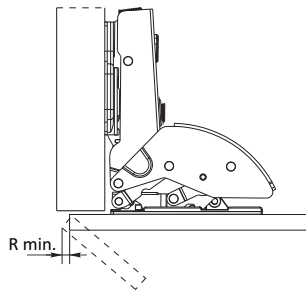

	T	3	4	5	6
K=1.5	R	13.6	14.4	15.2	16.1
K=3	R	11.2	12.1	12.9	13.8
K=4.5	R	8.9	9.8	10.7	11.6
K=6	R	6.8	7.7	8.6	9.5
K=7.5	R	4.2	5.0	5.8	6.6
K=8	R	2.8	3.8	4.8	5.8
	-	-	-	-	-
K=16.5	R	0	0	0.5	0.8

Gap Calculation

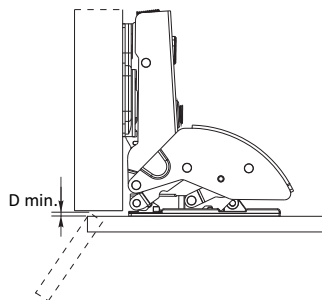

	T	3	4	5	6
K=1.5	D	0.0	0.0	0.0	0.0
K=3	D	0.0	0.0	0.0	0.0
K=3.5	D	0.0	0.0	0.0	0.0
-	D	0.0	0.0	0.0	0.0
K=16.5	D	0.0	0.0	0.0	0.0

The above values are calculated for squared edges (0.8mm Edge) , they are reduced for radiussed edges.

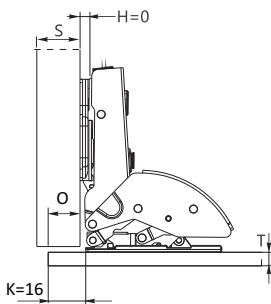

Full Overlay

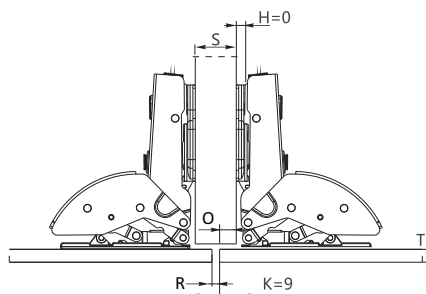

Half Overlay

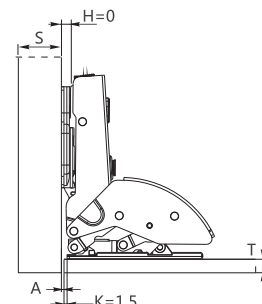

Inset



Features

- 45° cranked hinge with opening angle 95°
- Integrated soft-closing damper
- Range of door thickness 14-24mm
- Possible cup distance (K Value) 5mm
- Compliant to system 32
- Tested for 50,000 cycles
- Cam adjustable depth and clip-on mechanism
- Application on corner cabinets ensured full access to the furthest areas
- Made up of carbon steel with zinc plating
- Integrated overlay and depth adjustment upto ± 2 mm

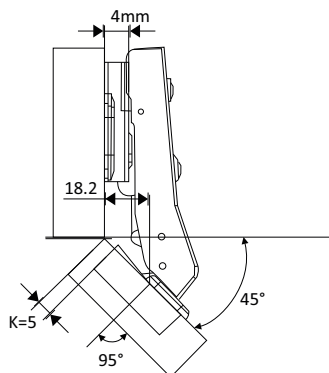
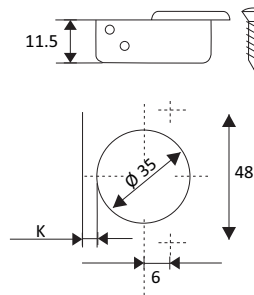
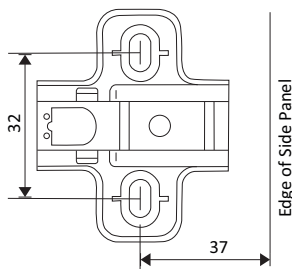

Features

- Opening angle 110°
- Integrated soft-closing damper
- Range of door thickness 14-24mm
- Possible cup distance (K Value) 3-7mm
- Compliant to system 32
- Tested for 50,000 cycles
- Cam adjustable depth and clip-on mechanism
- Made up of carbon steel with zinc plating
- Integrated overlay and depth adjustment upto ± 2 mm

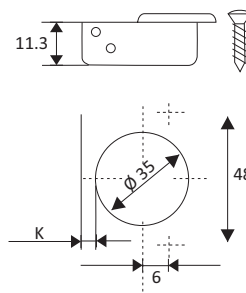
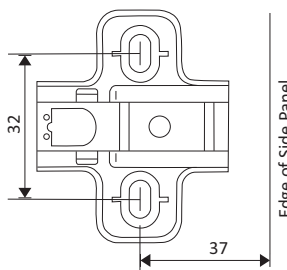

Reveal Calculation

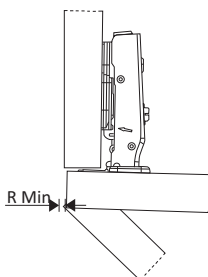

	T	14	15	16	17	18	19	20	21	22	23	24
K=3	R	0.2	0.4	0.6	0.8	1.1	1.5	2	2.7	3.5	4.3	5.1
K=4	R	0.2	0.4	0.6	0.8	1.1	1.4	1.9	2.4	3.1	3.9	4.7
K=5	R	0.2	0.3	0.5	0.8	1.0	1.4	1.8	2.3	2.9	3.5	4.3
K=6	R	0.2	0.3	0.5	0.7	1.0	1.3	1.7	2.1	2.6	3.3	4
K=7	R	0.2	0.3	0.5	0.7	0.9	1.2	1.6	2	2.5	3	3.7

Gap Calculation

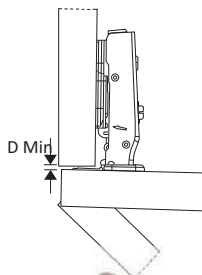

	T	14	15	16	17	18	19	20	21	22	23	24
K=3	D	0.0	0.0	0.0	0.1	0.3	0.5	0.7	0.8	1.0	1.2	1.4
K=4	D	0.6	0.8	1.0	1.1	1.3	1.5	1.7	1.8	2.0	2.2	2.3
K=5	D	1.6	1.8	1.9	2.1	2.3	2.5	2.6	2.8	3.0	3.2	3.3
K=6	D	2.6	2.8	2.9	3.1	3.3	3.4	3.6	3.8	4.0	4.1	4.3
K=7	D	3.6	3.7	3.9	4.1	4.3	4.4	4.6	4.8	5.0	5.1	5.3

The above values are calculated for squared edges (0.8mm Edge) , they are reduced for radiussed edges.

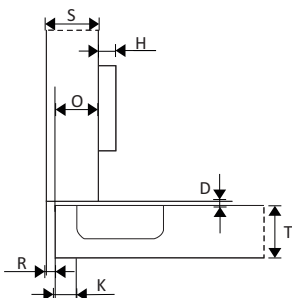

NAHCL041
O = 12 + K

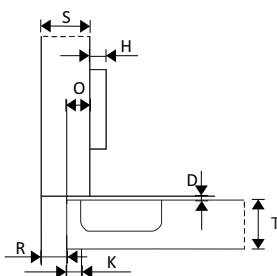

NAHCL042
O = 5 + K

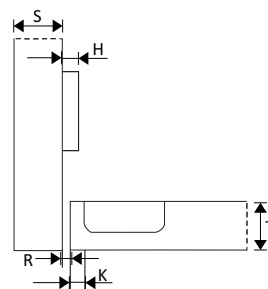

NAHCL043
O = -4 + K



Features

- Opening angle 95°
- Range of door thickness 20-40mm
- Possible cup distance (K Value) 3-15mm
- Compliant to system 32
- Tested for 50,000 cycles
- Twin spring for controlled opening
- Cam adjustable depth and clip-on mechanism
- Can overlay side panel up to 30mm
- Made up of carbon steel with zinc plating
- Integrated overlay and depth adjustment upto ± 2 mm

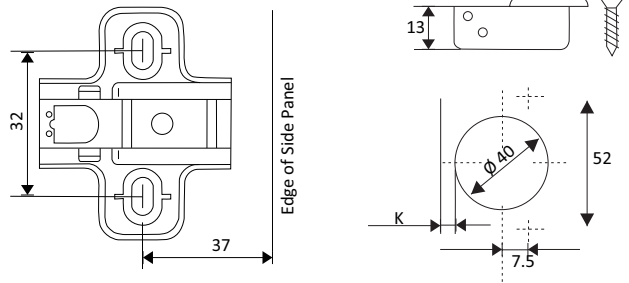

Reveal Calculation

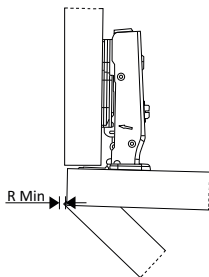

	T	20	21	22	23	24	25	26	27	28	29	30	31-40
K=3	R	0.3	0.5	0.6	0.8	1.0	1.2	1.4	1.6	1.9	2.2	2.5	2.8-9.7
K=4	R	0.3	0.5	0.6	0.8	1.0	1.2	1.4	1.6	1.9	2.1	2.4	2.8-9.1
K=5	R	0.3	0.5	0.6	0.8	0.9	1.1	1.4	1.6	1.8	2.1	2.4	2.7-8.5
K=6	R	0.3	0.5	0.6	0.8	0.9	1.1	1.3	1.6	1.8	2.1	2.3	2.7-7.9
K=7	R	0.3	0.4	0.6	0.7	0.9	1.1	1.3	1.5	1.8	2.0	2.3	2.6-7.3
K=8	R	0.3	0.4	0.6	0.7	0.9	1.1	1.3	1.5	1.7	2.0	2.3	2.6-6.9
	-	-	-	-	-	-	-	-	-	-	-	-	-
K=15	R	0.3	0.4	0.5	0.6	0.8	1.0	1.1	1.3	1.6	1.8	2.0	2.3-5.4

Gap Calculation

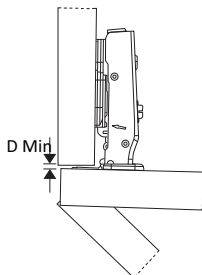

	T	20	21	22	23	24	25	26	27	28	29	30	31-40
K=3-9	D	0.0	0.0	0.0	0.0	0.0	0.0	0.0	0.0	0.0	0.0	0.0	0.0-0.0
K=10	D	0.0	0.0	0.0	0.0	0.0	0.0	0.0	0.0	0.0	0.0	0.1	0.1-0.8
K=11	D	0.4	0.5	0.6	0.7	0.7	0.8	0.9	0.9	1.0	1.1	1.1	1.2-1.8
K=12	D	1.4	1.5	1.6	1.7	1.7	1.8	1.9	1.9	2.0	2.1	2.2	2.2-2.8
K=13	D	2.4	2.5	2.6	2.7	2.7	2.8	2.9	2.9	3.0	3.1	3.2	3.2-3.8
K=14	D	3.4	3.5	3.6	3.6	3.7	3.8	3.9	3.9	4.0	4.1	4.2	4.2-4.8
K=15	D	4.4	4.5	4.6	4.6	4.7	4.8	4.9	4.9	5.0	5.1	5.2	5.2-5.8

The above values are calculated for squared edges (0.8mm Edge), they are reduced for radiussed edges.



NAHCL044

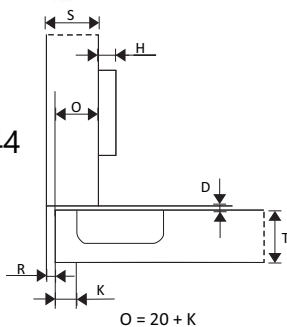

NAHCL045

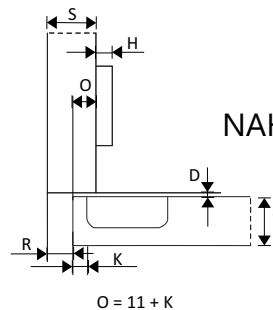

Features

- Opening angle 155°
- Integrated soft-closing damper
- Range of door thickness 14-26mm
- Possible cup distance (K Value) 3-6mm
- Compliant to system 32
- Tested for 50,000 cycles
- Twin spring for controlled opening
- Cam adjustable depth and clip-on mechanism
- Zero protrusion at maximum opening angle
- Integrated overlay and depth adjustment upto ± 2 mm

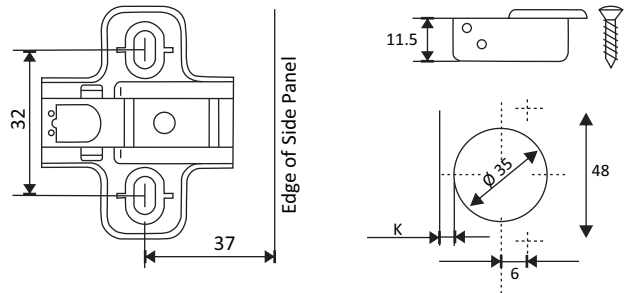

Reveal Calculation

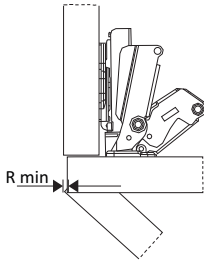

	T	16	17	18	19	20	21	22	23	24
K=3	R	0	0	0	0	0	0	0	0	0
K=4	R	0	0	0	0	0	0	0	0	0
K=5	R	0	0	0	0	0	0	0	0	0
K=6	R	0	0	0	0	0	0	0	0	0

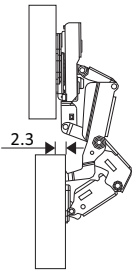

Diagram showing door protrusion of 2.3mm at 90° opening angle.

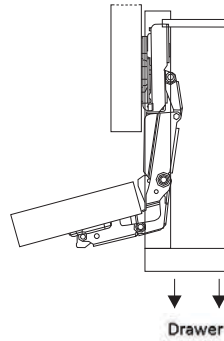
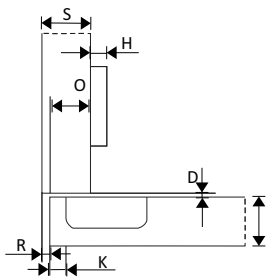
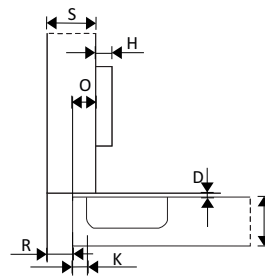

Diagram showing zero door protrusion at maximum opening angle.



NAHCL047

$$O = 11 + K$$



NAHCL050

$$O = 2 + K$$



Features

- Opening angle 110°
- Unsprung hinges suitable for push to open operations
- Compliant to system 32
- Virtually infinite product life cycles
- To be used along with NCA005 & NCA006
- Cam adjustable depth and clip-on mechanism
- Made up of carbon steel with zinc plating
- Integrated overlay and depth adjustment upto $\pm 2\text{mm}$

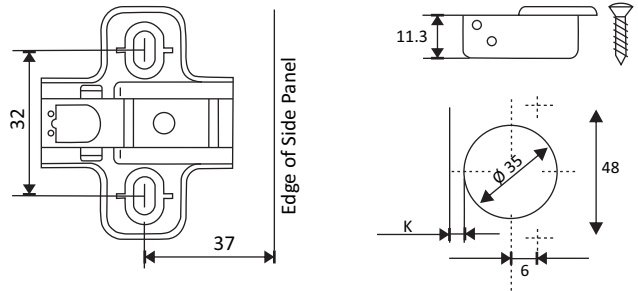

Reveal Calculation

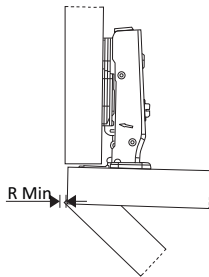

	T	14	15	16	17	18	19	20	21	22	23	24
K=3	R	0.2	0.4	0.6	0.8	1.1	1.5	2	2.7	3.5	4.3	5.1
K=4	R	0.2	0.4	0.6	0.8	1.1	1.4	1.9	2.4	3.1	3.9	4.7
K=5	R	0.2	0.3	0.5	0.8	1.0	1.4	1.8	2.3	2.9	3.5	4.3
K=6	R	0.2	0.3	0.5	0.7	1.0	1.3	1.7	2.1	2.6	3.3	4
K=7	R	0.2	0.3	0.5	0.7	0.9	1.2	1.6	2	2.5	3	3.7

Gap Calculation

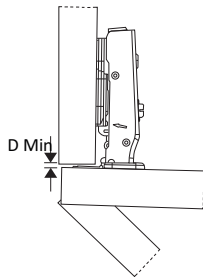

	T	14	15	16	17	18	19	20	21	22	23	24
K=3	D	0.0	0.0	0.0	0.1	0.3	0.5	0.7	0.8	1.0	1.2	1.4
K=4	D	0.6	0.8	1.0	1.1	1.3	1.5	1.7	1.8	2.0	2.2	2.3
K=5	D	1.6	1.8	1.9	2.1	2.3	2.5	2.6	2.8	3.0	3.2	3.3
K=6	D	2.6	2.8	2.9	3.1	3.3	3.4	3.6	3.8	4.0	4.1	4.3
K=7	D	3.6	3.7	3.9	4.1	4.3	4.4	4.6	4.8	5.0	5.1	5.3

The above values are calculated for squared edges (0.8mm Edge), they are reduced for radiussed edges.

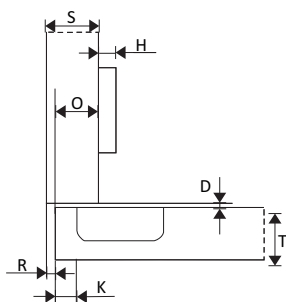

NAHCL221

$$O = 12 + K$$

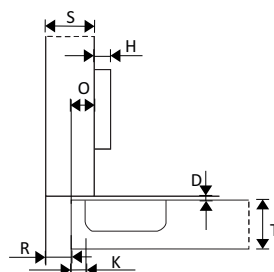

NAHCL222

$$O = 5 + K$$

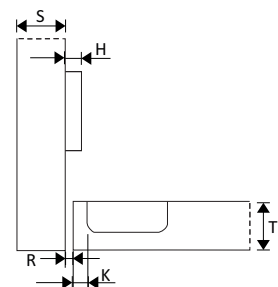

NAHCL223

$$O = -4 + K$$



Features

- Maximum opening angle 135°
- Range of door thickness 14-24mm
- Possible cup distance (K Value) 3-7mm
- Compliant to system 32
- Tested for 50,000 cycles
- Adjustable opening angle
- Made up of carbon steel with zinc plating
- Integrated overlay and depth adjustment upto $\pm 2\text{mm}$

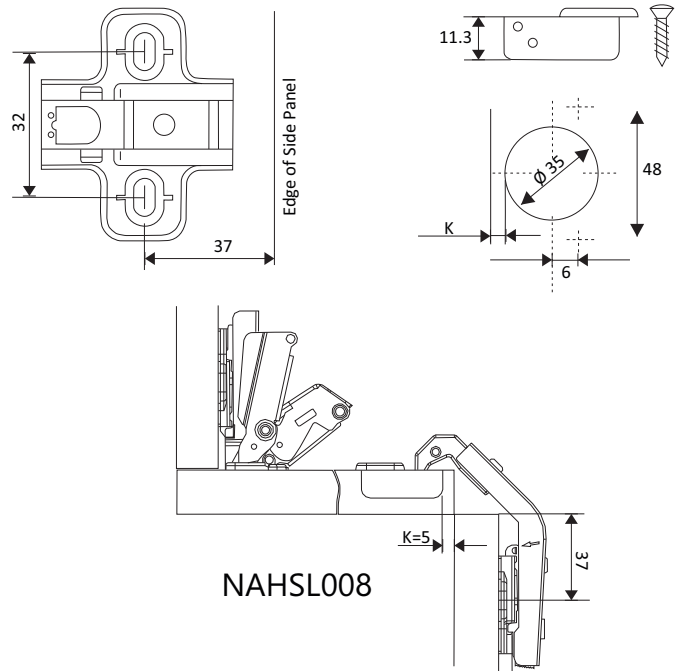

Concealed Hinges-NAHCL028

Features

- Maximum opening angle 135°
- Range of door thickness 14-24mm
- Possible cup distance (K Value) 3-7mm
- Compliant to system 32
- Tested for 50,000 cycles
- Adjustable opening angle
- Cam adjustable depth and clip-on mechanism
- Made up of carbon steel with zinc plating
- Integrated overlay and depth adjustment upto $\pm 2\text{mm}$

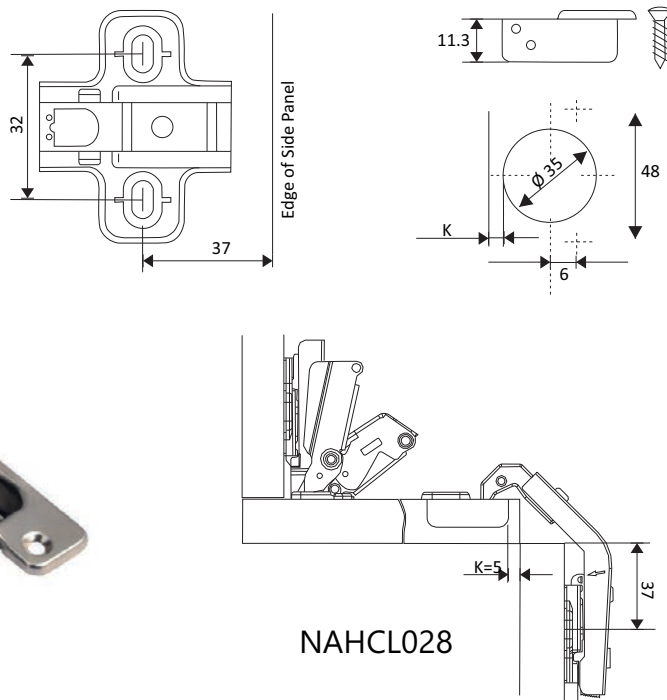

Features

- Opening angle 110°
- Integrated soft-closing damper
- Range of door thickness 14-24mm
- Possible cup distance (K Value) 3-7mm
- Compliant to system 32
- Tested for 50,000 cycles
- Twin spring for controlled opening
- Cam adjustable depth and clip-on mechanism
- Made up of carbon steel with zinc plating
- Integrated overlay and depth adjustment upto ± 2 mm

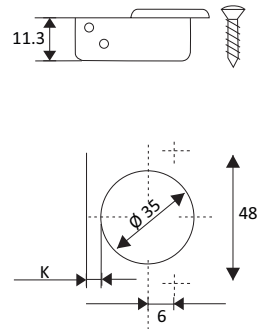
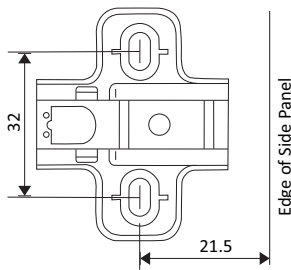

NAHCL029 (Regular)



NAHCL049 (Soft Close)

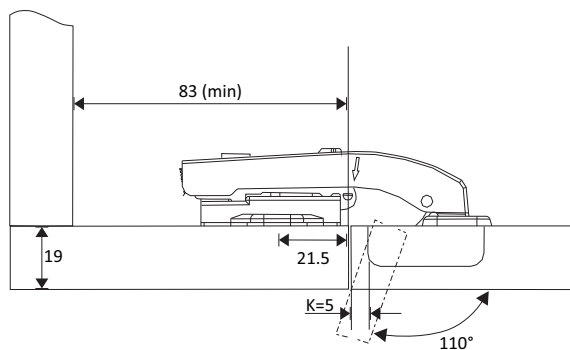

NAHCL029 (Regular)
NAHCL049 (Soft Close)



Concealed Hinges-NAHCL051/52/53 (NK/BK)



Features

- Opening angle 110°
- Integrated soft-closing damper
- Range of door thickness 14-24mm
- Possible cup distance (K Value) 3-7mm
- Compliant to system 32
- Tested for 50,000 cycles
- Cam adjustable depth and clip-on mechanism
- Made up of carbon steel with zinc plating
- Integrated overlay and depth adjustment upto ± 2 mm
- Comes with Cover and Arm caps

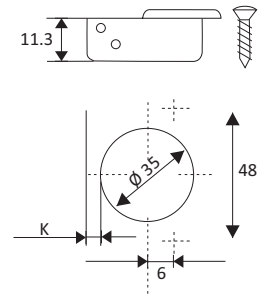
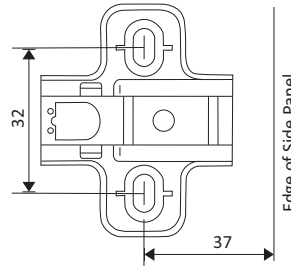

Full overlay



Half overlay

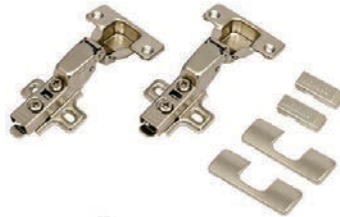

Inset

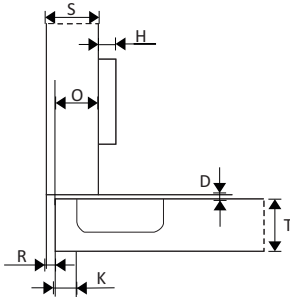

NAHCL051
 $O = 12 + K$

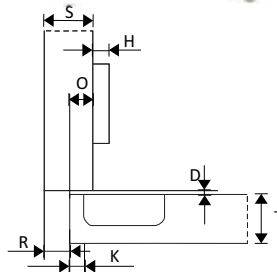

NAHCL052
 $O = 5 + K$

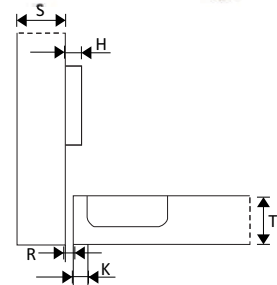

NAHCL053
 $O = -4 + K$



Concealed Hinges-NAHCL059



Features

- Opening angle 165°
- Range of door thickness 14-22mm
- Possible cup distance (K Value) 3-7mm
- Compliant to system 32
- Tested for 50,000 cycles
- Available in Black & Nickel finish also
- Zero protrusion at maximum opening angle
- Cam adjustable depth and clip-on mechanism
- Made up of carbon steel with zinc plating
- Integrated overlay and depth adjustment upto ± 2 mm

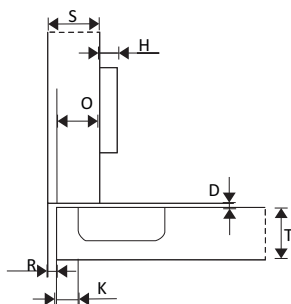
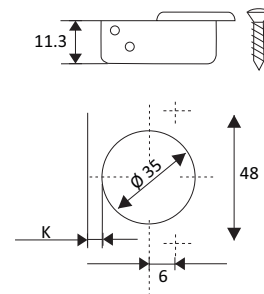
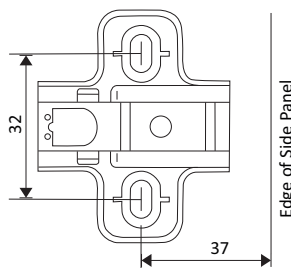

NAHCL027

$$O = 12 + K$$

